

SECTION A-A

THREAD DETAIL INFORMATION
6 THREADS PER INCH, 0.167 PITCH

REFERENCE	TOLERANCE	DIMENSION	UNITS
E	±0.030 [0.76]	1.795 [45.59]	in [mm]
T	+0.035 [0.89] -0.030 [0.76]	1.885 [47.88]	in [mm]
H	±0.010 [0.25]	0.618 [15.70]	in [mm]
OD	+0.035 [0.89] -0.030 [0.76]	1.985 [50.42]	in [mm]
OAH	±0.010 [0.25]	0.766 [19.46]	in [mm]
PART WEIGHT	± 0.3	7.2	g
OPENING FORCE LARGE FLAP	± 2.5	4.5	lbf
OPENING FORCE SMALL FLAP	± 2.75	4.25	lbf

STATIC TORQUE RECOMMENDATION
19-30 in-lbs
THIS REQUIREMENT MAY VARY DEPENDING
UPON BOTTLE MATERIAL, NECK FINISH, AND
CAPPING EQUIPMENT

DRAWING TYPE : **CUSTOMER**

REPLACES DRAWINGS:
S-162-01-01

DIMENSIONS ENCLOSED IN ()
INDICATE REFERENCE
DIMENSIONS AND NO TOLERANCE
LIMITS ARE ESTABLISHED

TOLERANCES UNLESS OTHERWISE SPECIFIED

DIMENSION (inches)	TOLERANCE	DIMENSION (mm)	TOLERANCE
0-0.787	±0.006	0-20	±0.152
0.788-1.181	±0.008	21-30	±0.203
1.182-2.756	±0.012	31-70	±0.305
2.757-3.937	±0.016	71-100	±0.406
3.938-5.096	±0.020	101-150	±0.508
5.097-7.874	±0.024	151-200	±0.610
7.875-9.843	±0.032	201-250	±0.813

ANGULAR TOLERANCE ± 2°

PROPRIETARY AND CONFIDENTIAL

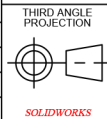

DISTRIBUTION
CODE
D

DRAWING NAME
**48-485 DUAL FLAPPER
200/POUR**

DRAWING NUMBER
CQA - 10448

MATERIAL
POLYPROPYLENE

MODEL NUMBER:
PM 10446 48-485 DF

SCALE	SHEET SIZE	SHEET	REV.NP
1:1	8.5 X 11	1 of 3	00.AA

DRAWN BY.	DAS	1/10/2017
ENG APPR.	BDG	1/16/2017
QA APPR.	CAB	1/30/2017

THE CLOSURE DIMENSIONS
DEPICTED ARE THOSE WHICH HAVE GENERALLY BEEN
FOUND TO BE FUNCTIONAL BASED ON INDUSTRY
EXPERIENCE BECAUSE OF VARIABILITY IN GLASS AND
PLASTIC CONTAINER FINISHES. EACH CLOSURE/FINISH
SYSTEM SHOULD BE INDIVIDUALLY EVALUATED AND
TESTED TO ENSURE IT MEETS APPLICABLE
PERFORMANCE CRITERIA. SEE QUALITY ASSURANCE
SPECIFICATIONS FOR ADDITIONAL INFORMATION.

DATE	REV.	N/P	DESCRIPTION	ENG	DRW
1/10/2017	AA	00	UPDATED DRAWING FORMAT	BDG	DAS

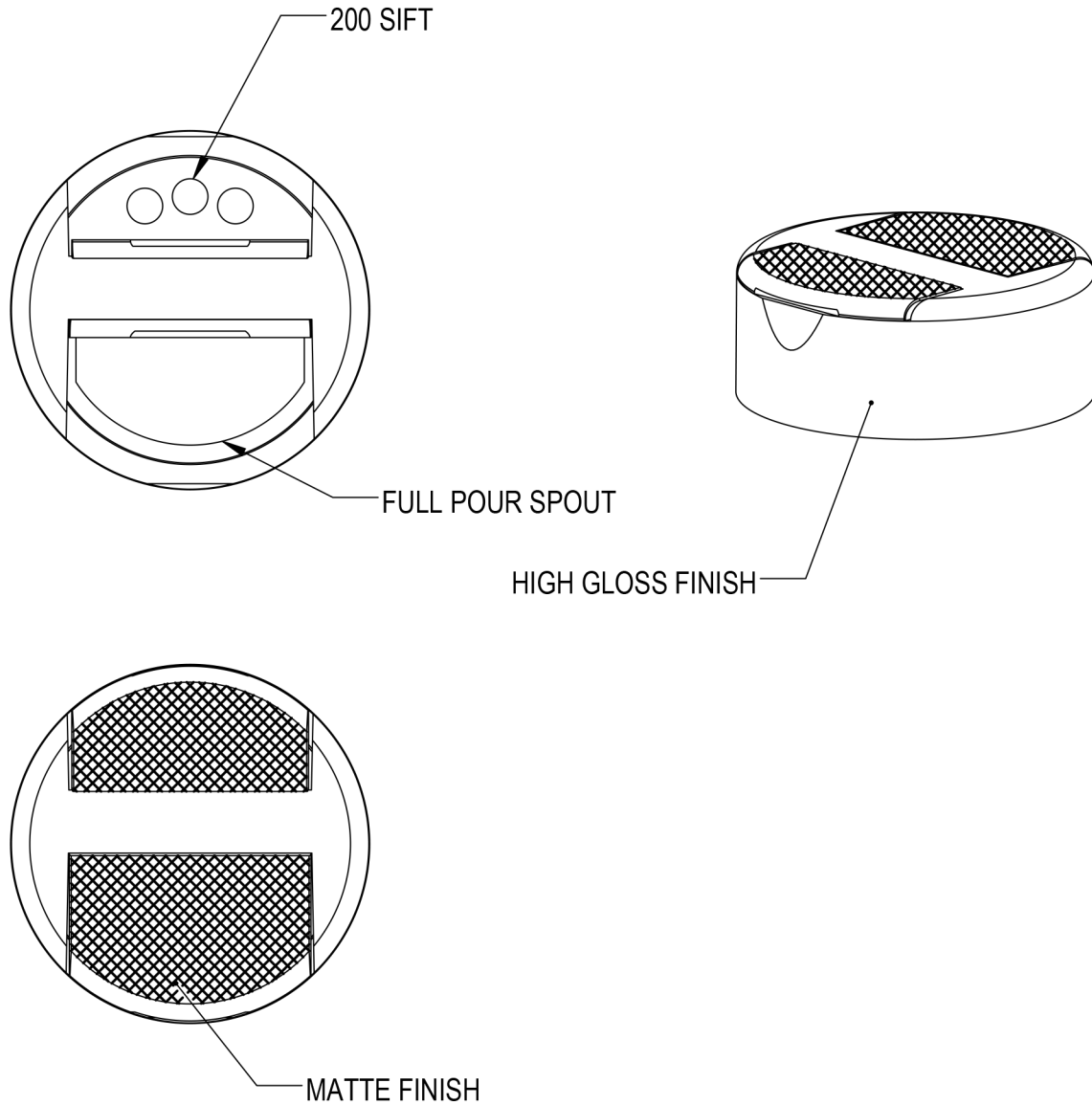

THE CLOSURE DIMENSIONS DEPICTED ARE THOSE WHICH HAVE GENERALLY BEEN FOUND TO BE FUNCTIONAL BASED ON INDUSTRY EXPERIENCE BECAUSE OF VARIABILITY IN GLASS AND PLASTIC CONTAINER FINISHES. EACH CLOSURE/FINISH SYSTEM SHOULD BE INDIVIDUALLY EVALUATED AND TESTED TO ENSURE IT MEETS APPLICABLE PERFORMANCE CRITERIA. SEE QUALITY ASSURANCE SPECIFICATIONS FOR ADDITIONAL INFORMATION.

DRAWING TYPE : CUSTOMER			
REFERENCES: 162		DIMENSIONS ENCLOSED IN () INDICATE REFERENCE DIMENSIONS AND NO TOLERANCE LIMITS ARE ESTABLISHED	
TOLERANCES UNLESS OTHERWISE SPECIFIED			
DIMENSION (inches)	TOLERANCE	DIMENSION (mm)	TOLERANCE
0-0.787	±0.006	0-20	±0.152
0.788-1.181	±0.008	21-30	±0.203
1.182-2.756	±0.012	31-70	±0.305
2.757-3.937	±0.016	71-100	±0.406
3.938-5.096	±0.020	101-150	±0.508
5.097-7.874	±0.024	151-200	±0.610
7.875-9.843	±0.032	201-250	±0.813
ANGULAR TOLERANCE ± 2°			
PROPRIETARY AND CONFIDENTIAL			



THIRD ANGLE PROJECTION	DISTRIBUTION CODE D	DRAWING NAME 48-485 DUAL FLAPPER 200/POUR	
		DRAWING NUMBER CQA - 10448	
DRAWN BY. DAS	1/10/2017	MATERIAL POLYPROPYLENE	
ENG APPR. BDG	1/16/2017	MODEL NUMBER: PM 10446 48-485 DF	
QA APPR. CAB	1/30/2017	SCALE 1:1	SHEET SIZE 8.5 X 11
		SHEET 2 of 3	REV.NP

CRITICAL FOR OREINTATIONS
 0.001"= 2 IN ROTATION
 S' .181
 [4.6]

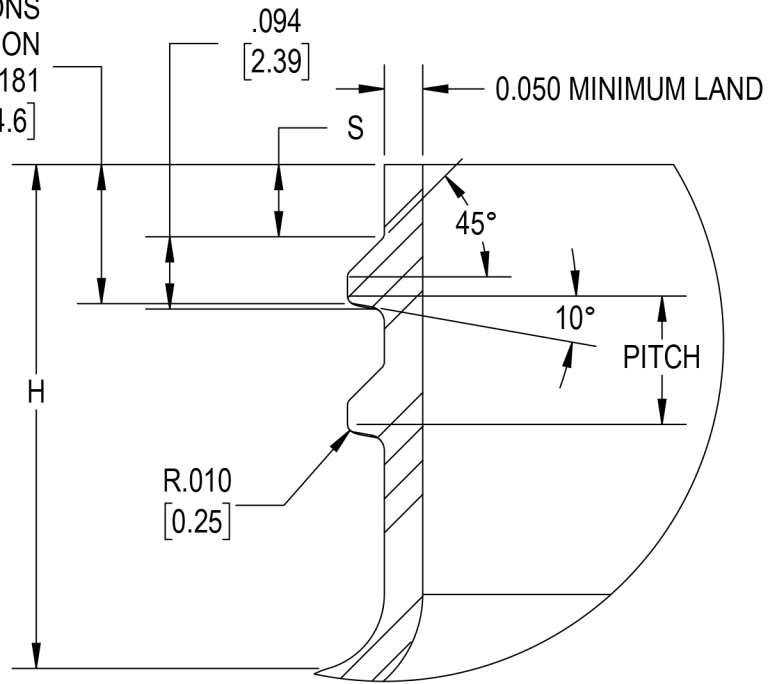

DETAIL THREAD
 SCALE 4 : 1

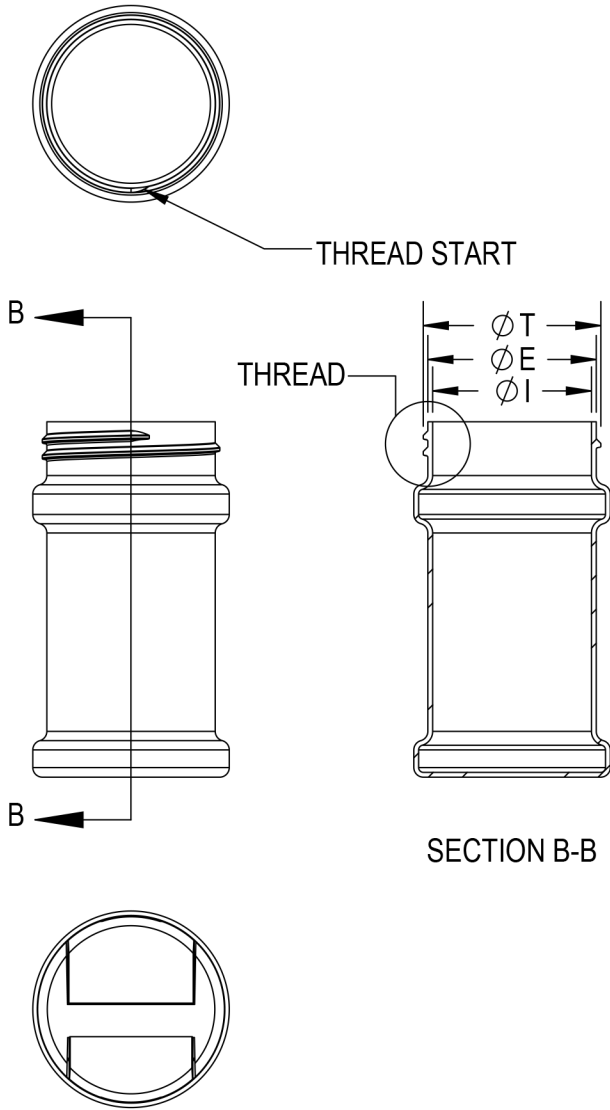

REFERENCE	TOLERANCE	UNITS	DIMENSION
E	±0.015 [0.38]	in	1.754 [44.55]
T	±0.015 [0.38]	in	1.850 [46.99]
I	MIN	in	1.500 [38.10]
S	±0.015 [0.38]	in	0.093 [2.36]
H	MIN	in	0.640 [16.26]
TPI			6
PITCH	TPI	in	0.167

NOTE: THE NOMINAL ORIENTATION ILLUSTRATED IS BASED ON NOMINAL DIMENSIONS OF BOTH THE CLOSURE AND THE RECOMMENDED NECK FINISH. FOR EXACT ORIENTATION EACH BOTTLE SHOULD BE EVALUATED ON A CASE BY CASE BASIS.

THE CLOSURE DIMENSIONS DEPICTED ARE THOSE WHICH HAVE GENERALLY BEEN FOUND TO BE FUNCTIONAL BASED ON INDUSTRY EXPERIENCE BECAUSE OF VARIABILITY IN GLASS AND PLASTIC CONTAINER FINISHES, EACH CLOSURE/FINISH SYSTEM SHOULD BE INDIVIDUALLY EVALUATED AND TESTED TO ENSURE IT MEETS APPLICABLE PERFORMANCE CRITERIA. SEE QUALITY ASSURANCE SPECIFICATIONS FOR ADDITIONAL INFORMATION.

DRAWING TYPE : CUSTOMER

REFERENCE B-13008-AA	DIMENSIONS ENCLOSED IN () INDICATE REFERENCE DIMENSIONS AND NO TOLERANCE LIMITS ARE ESTABLISHED		
TOLERANCES UNLESS OTHERWISE SPECIFIED			
DIMENSION (inches)	TOLERANCE	DIMENSION (mm)	TOLERANCE
0-0.787	±0.006	0-20	±0.152
0.788-1.181	±0.008	21-30	±0.203
1.182-2.756	±0.012	31-70	±0.305
2.757-3.937	±0.016	71-100	±0.406
3.938-5.096	±0.020	101-150	±0.508
5.097-7.874	±0.024	151-200	±0.610
7.875-9.843	±0.032	201-250	±0.813
ANGULAR TOLERANCE ± 2°			
PROPRIETARY AND CONFIDENTIAL			



THIRD ANGLE PROJECTION	DISTRIBUTION CODE D	DRAWING NAME 48-485 DUAL FLAPPER RECOMMENDED NECH FINISH
DRAWING NUMBER CQA - 10448		MATERIAL
DRAWN BY: DAS	1/10/2017	MODEL NUMBER:
ENG APPR: BDG	1/16/2017	SCALE: 1:2
QA APPR: CAB	1/30/2017	SHEET SIZE: 8.5X11
		SHEET: 3 of 3
		REV/N/P: 00.AA